

Mon Jul 21 2014

Concealed Water Cooled Package Unit

Technical Data



Cooling Capacity

Model	Air flow l/sec	Water flow l/sec	Air On Condition		Leaving Water Temperature																	
			db° C	wb° C	25			30			35			40			45			50		
					Total Cap kW	Sens Cap kW	Heat Rej. kW	Total Cap kW	Sens Cap kW	Heat Rej. kW	Total Cap kW	Sens Cap kW	Heat Rej. kW	Total Cap kW	Sens Cap kW	Heat Rej. kW	Total Cap kW	Sens Cap kW	Heat Rej. kW	Total Cap kW	Sens Cap kW	Heat Rej. kW
CWPO063	380	0.42	23	17	6.48	5.10	8.0	6.18	4.73	7.7	5.89	4.51	7.6	5.63	4.40	7.4	5.54	4.20	7.3	5.48	3.82	7.3
			27	19	6.94	5.11	8.5	6.86	5.02	8.5	6.27	5.0	8.0	6.11	4.73	7.9	5.63	4.66	7.4	5.54	4.57	7.4
			31	21	7.40	4.91	9.0	7.34	5.88	9.0	7.27	5.86	9.1	6.64	5.80	8.5	6.35	5.71	8.2	6.00	5.66	7.9
CWPO083	490	0.5	23	17	8.59	7.12	10.1	8.19	6.62	9.8	7.81	6.31	9.6	7.47	6.16	9.3	7.35	5.88	9.6	7.26	5.34	9.3
			27	19	9.20	7.15	10.7	9.09	7.03	10.7	8.31	7.00	10.1	8.10	6.62	10.0	7.47	6.53	9.3	7.35	6.40	9.4
			31	21	9.81	8.27	11.4	9.72	8.24	11.3	9.64	8.21	11.5	8.80	8.12	10.7	8.42	8.21	10.4	7.96	7.93	10.0
CWPO096	570	0.58	23	17	9.96	7.93	11.7	9.49	7.38	11.3	9.05	7.03	11.18	8.52	6.55	10.8	8.42	5.96	10.8	8.42	5.96	10.8
			27	19	10.67	7.97	12.4	10.53	7.83	12.4	9.63	7.80	11.70	8.65	7.28	10.9	8.52	7.14	11.6	8.52	7.14	10.9
			31	21	11.37	9.22	13.2	11.27	9.18	13.1	11.17	9.15	12.4	9.76	8.90	12.1	9.22	8.84	12.4	9.22	8.84	11.6
CWPO109	600	0.67	23	17	11.27	8.95	13.3	10.74	8.33	12.9	10.25	7.93	12.7	9.79	7.74	12.3	9.64	7.39	12.2	9.79	6.72	12.2
			27	19	12.07	8.99	14.1	11.92	8.83	14.1	10.90	8.80	13.3	10.63	8.33	13.2	9.79	8.21	12.3	9.64	8.05	12.3
			31	21	12.87	10.40	15.0	12.76	10.36	14.9	12.64	10.32	15.2	11.54	10.20	14.1	11.05	10.05	13.7	10.44	9.97	13.2
CWPO132	770	0.8	23	17	13.59	10.68	16.0	12.95	9.94	15.5	12.36	9.47	15.2	11.81	9.24	14.8	11.62	8.82	14.7	11.49	8.02	14.7
			27	19	14.55	10.73	17.0	14.37	10.54	17.0	13.14	10.50	16.0	12.81	9.94	15.95	11.81	9.80	14.87	11.62	9.61	14.8
			31	21	15.52	12.41	18.15	15.38	12.36	18.0	15.24	12.32	18.3	13.91	12.18	17.0	13.32	11.99	16.5	12.59	11.90	15.9
CWPO178	920	1.08	23	17	18.41	14.24	21.7	17.55	13.25	21.1	16.74	12.63	20.7	16.00	12.32	20.1	15.75	11.76	20.0	15.67	10.70	19.9
			27	19	19.72	14.31	23.0	19.47	14.06	23.1	17.80	14.00	21.7	17.36	13.25	21.6	16.00	13.06	20.1	15.75	12.81	20.1
			31	21	21.02	16.55	24.6	20.83	16.48	24.4	20.65	16.42	24.8	18.85	16.24	23.1	18.04	15.99	22.46	17.05	15.86	21.5
CWPO217	1210	1.34	23	17	22.49	17.81	26.57	21.43	16.56	25.82	20.45	15.78	25.33	19.54	15.40	25.46	19.24	14.70	24.48	19.01	13.37	24.40
			27	19	24.08	17.88	25.62	23.78	17.57	25.69	21.74	17.50	24.08	21.20	16.56	24.00	19.54	16.33	22.39	19.24	16.02	22.39
			31	21	25.67	20.68	27.31	25.45	20.61	27.10	25.22	20.53	27.60	23.02	20.30	25.69	22.04	19.98	24.92	20.83	19.83	23.93
CWPO266	1535	1.6	23	17	27.19	17.81	32.39	25.91	16.56	34.44	24.72	15.78	30.8	23.62	15.40	29.93	23.25	14.70	29.8	22.98	13.37	29.74
			27	19	29.11	17.88	34.37	28.75	17.57	34.4	26.28	17.50	32.3	25.63	16.57	32.2	23.62	16.33	30.0	23.25	16.02	30.0
			31	21	31.04	20.68	36.6	30.76	20.61	36.3	30.49	20.53	37.0	27.83	20.30	34.47	26.64	19.98	33.4	25.18	19.83	32.1
CWPO374	1940	2.27	23	17	38.74	30.32	45.0	36.91	28.21	43.7	35.22	26.88	42.9	33.65	26.22	41.6	33.13	25.03	41.4	32.74	22.78	41.3
			27	19	41.48	30.46	47.7	40.96	29.93	47.9	37.44	29.80	44.9	36.52	28.21	44.7	33.65	27.81	41.7	36.52	27.28	41.7
			31	21	44.22	35.23	50.9	43.83	35.09	50.5	43.44	34.95	51.4	39.65	34.56	47.9	37.96	34.03	46.4	35.87	33.77	44.6
CWPO447	2315	2.6	23	17	46.25	35.52	54.5	44.07	33.03	52.9	42.05	31.48	52.0	40.18	30.71	50.4	39.56	29.31	50.26	39.09	26.67	50.1
			27	19	49.52	35.67	57.8	48.90	35.05	58.0	44.70	34.90	54.4	43.60	33.03	54.2	40.18	32.57	50.58	39.56	31.95	50.5
			31	21	52.79	41.25	61.7	52.33	41.10	61.2	51.86	40.94	62.3	47.34	40.48	58.0	45.32	39.86	56.30	42.83	39.55	54.0
CWPO568	2935	3.4	23	17	59.75	42.64	68.5	56.93	39.66	66.5	54.32	37.80	65.4	51.90	36.87	63.3	51.10	35.19	63.1	50.49	32.03	62.9
			27	19	63.97	42.83	72.9	63.17	42.08	72.9	57.74	41.90	68.4	56.33	39.66	68.1	51.90	39.10	63.5	51.10	38.36	63.5
			31	21	68.20	49.53	77.5	67.59	49.34	76.9	65.99	49.16	78.4	61.1	48.6	72.9	58.54	47.85	70.7	55.32	47.48	67.9
CWPO890	4800	4.9	23	17	92.09	71.14	107.3	87.76	66.17	104.1	87.72	63.06	102.3	80.00	61.51	99.1	78.76	58.71	98.8	77.83	53.43	98.5
			27	19	98.61	71.45	113.8	97.37	70.21	114.1	89.00	69.90	107.0	86.82	66.17	106.6	80.00	65.24	99.4	78.76	63.99	99.4
			31	21	103.26	82.63	121.3	104.19	82.32	120.4	103.26	82.01	122.6	94.21	81.08	114.1	90.24	79.84	110.7	85.27	79.21	106.3
CWPO1030	4960	5.7	23	17	105.13	80.60	122.9	100.18	74.97	119.3	95.58	71.45	117.22	91.33	69.69	113.6	89.91	66.52	113.2	88.85	60.54	112.9
			27	19	112.57	80.95	130.4	111.15	79.55	130.8	101.60	79.20	122.6	99.12	74.97	122.2	91.33	73.92	113.9	89.91	72.51	113.9
			31	21	120.00	93.63	139.0	118.94	93.27	138.0	117.88	92.92	140.52	107.61	91.87	130.8	103.01	90.46	126.9	97.35	89.75	121.8

Note:

Capacities are gross and do not allow for fan motor heat loss - refer to Air Handling Performance.

Red Font = Nominal Capacity

Water Flow and Cooling Capacity based on ΔT of 5°C



Heating Capacity

Model	Air flow l/s	Water flow l/s	Air On Condition db °C	Leaving Water Temperature											
				12.5				15.5				18.5			
				Cap kW	Heat Absorb ed kW	Entering Water Temp °C	Input kW	Cap kW	Heat Absorb ed kW	Entering Water Temp °C	Input kW	Cap kW	Heat Absorb ed kW	Entering Water Temp °C	Input kW
CWPO063	380	0.42	18	6.23	4.96	15.32	1.27	6.67	5.36	18.6	1.32	7.16	5.78	22.49	1.37
			21	6.18	4.85	15.26	1.33	6.63	5.23	18.5	1.40	7.14	5.67	22.45	1.46
			25	6.16	4.73	15.18	1.44	6.63	5.12	18.4	1.50	7.09	5.51	22.45	1.57
CWPO083	490	0.5	18	7.84	6.29	15.5	1.54	8.39	6.79	18.7	1.60	9.01	7.32	22.00	1.68
			21	7.78	6.15	15.4	1.62	8.34	6.63	18.7	1.71	8.98	7.19	21.93	1.79
			25	7.75	5.99	15.3	1.76	8.34	6.49	18.6	1.84	8.92	6.99	21.84	1.92
CWPO096	570	0.58	18	9.01	6.62	15.22	2.38	9.64	7.18	18.5	2.46	10.35	7.76	21.69	2.58
			21	8.94	6.43	15.15	2.50	9.58	6.95	18.4	2.63	10.31	7.56	21.61	2.75
			25	8.91	6.19	15.05	2.71	9.58	6.74	18.3	2.83	10.24	7.29	21.50	2.95
CWPO109	600	0.67	18	9.65	6.94	14.97	2.71	10.34	7.52	18.2	2.81	11.09	8.14	21.40	2.95
			21	9.58	6.72	14.89	2.85	10.27	7.27	18.1	3.00	11.06	7.91	21.32	3.14
			25	9.55	6.45	14.80	3.09	10.27	7.03	18.0	3.23	10.98	7.61	21.24	3.37
CWPO132	770	0.8	18	11.19	7.90	14.86	3.28	11.98	8.54	18.1	3.39	12.85	9.28	21.27	3.56
			21	11.10	7.65	14.78	3.45	11.90	8.27	18.0	3.62	12.81	9.02	21.19	3.79
			25	11.06	7.32	14.68	3.73	11.90	7.99	17.9	3.90	12.73	8.65	21.08	4.07
CWPO178	920	1.08	18	15.43	11.07	14.94	4.35	16.52	12.01	18.2	4.50	17.72	12.99	21.37	4.73
			21	15.31	10.73	14.87	4.58	16.41	11.60	18.1	4.81	17.67	12.63	21.29	5.03
			25	15.26	10.30	14.77	4.96	16.41	11.22	18.0	5.18	17.55	12.14	21.18	5.41
CWPO217	1210	1.34	18	19.31	13.88	14.97	5.43	20.68	15.05	18.2	5.62	22.19	16.28	21.4	5.90
			21	19.17	13.45	14.89	5.71	20.54	14.54	18.1	6.00	22.11	15.83	21.32	6.28
			25	19.10	12.91	14.80	6.18	20.54	14.14	18.1	6.46	21.97	15.22	21.21	6.75
CWPO266	1535	1.6	18	22.38	15.81	14.86	6.79	23.96	17.16	18.1	6.7	25.71	18.57	21.27	7.13
			21	22.21	15.30	14.78	7.25	23.80	16.55	18.0	7.2	25.63	18.04	21.19	7.58
			25	22.13	14.65	15.68	7.81	23.80	15.98	17.9	7.8	25.46	17.30	21.08	8.15
CWPO374	1940	2.27	18	33.38	24.41	15.06	8.97	35.74	26.46	18.3	7.04	38.35	28.60	21.51	9.74
			21	33.14	23.70	14.99	9.43	35.50	25.60	18.2	7.46	38.23	27.86	21.43	10.36
			25	33.01	22.80	14.89	10.20	35.50	24.82	18.1	8.09	37.98	26.84	21.32	11.13
CWPO447	2315	2.6	18	43.85	32.92	15.46	11.56	46.95	34.99	18.7	11.96	50.38	37.81	21.97	12.56
			21	43.53	31.37	15.38	12.16	46.63	33.87	18.6	12.76	50.21	36.85	21.88	13.35
			25	43.36	30.21	15.27	13.15	46.63	32.87	18.5	13.75	49.89	35.53	21.76	14.35
CWPO568	2935	3.4	18	51.67	38.08	15.17	13.59	55.32	41.26	18.40	14.06	59.35	44.59	21.63	14.76
			21	51.28	36.99	15.09	14.29	54.94	39.94	18.30	15.00	59.16	43.46	21.55	15.70
			25	51.09	35.62	15.00	15.16	54.94	38.76	18.20	16.17	58.78	41.90	21.44	16.87
CWPO890	4800	4.9	18	79.38	56.05	15.23	23.32	84.99	60.85	18.5	24.13	91.18	65.84	21.71	25.3
			21	78.79	54.25	15.14	24.53	84.40	58.66	18.4	25.74	90.89	63.94	21.61	26.9
			25	78.49	51.95	15.03	26.54	84.40	56.64	18.3	27.75	90.30	61.34	21.49	28.9
CWP1030	4960	5.7	18	92.73	65.00	15.22	27.73	99.28	70.60	18.5	28.68	106.52	76.40	21.70	30.12
			21	92.04	62.88	15.13	29.16	98.60	68.00	18.3	30.60	106.18	74.14	21.60	32.03
			25	91.70	60.14	15.02	31.55	98.60	65.61	18.3	32.99	105.49	71.07	21.47	34.42

Note:

Red Font = Nominal Capacity



CWP0063 Air Handling Performance
Without Filter

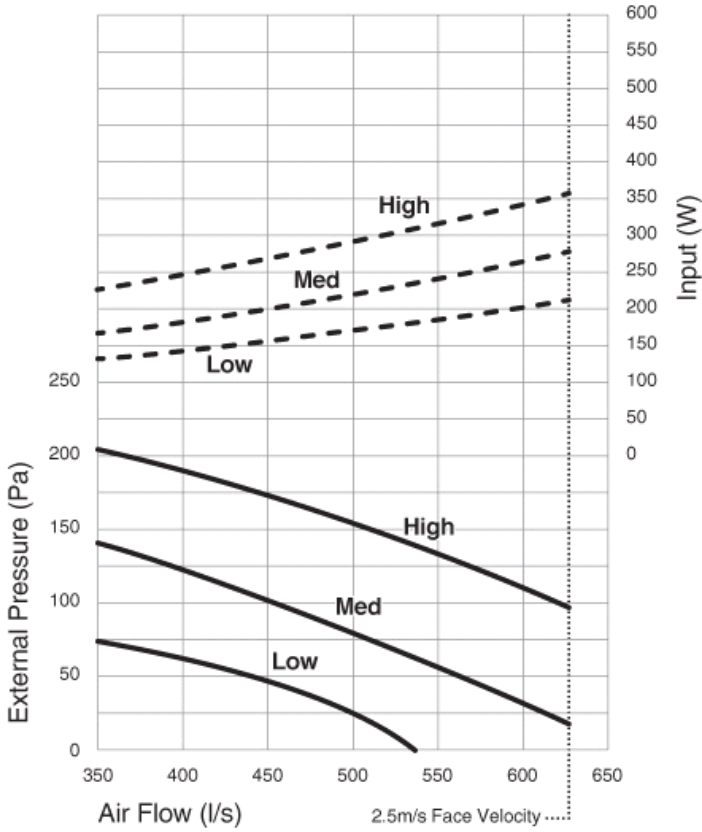

CWP0083 Air Handling Performance
Without Filter

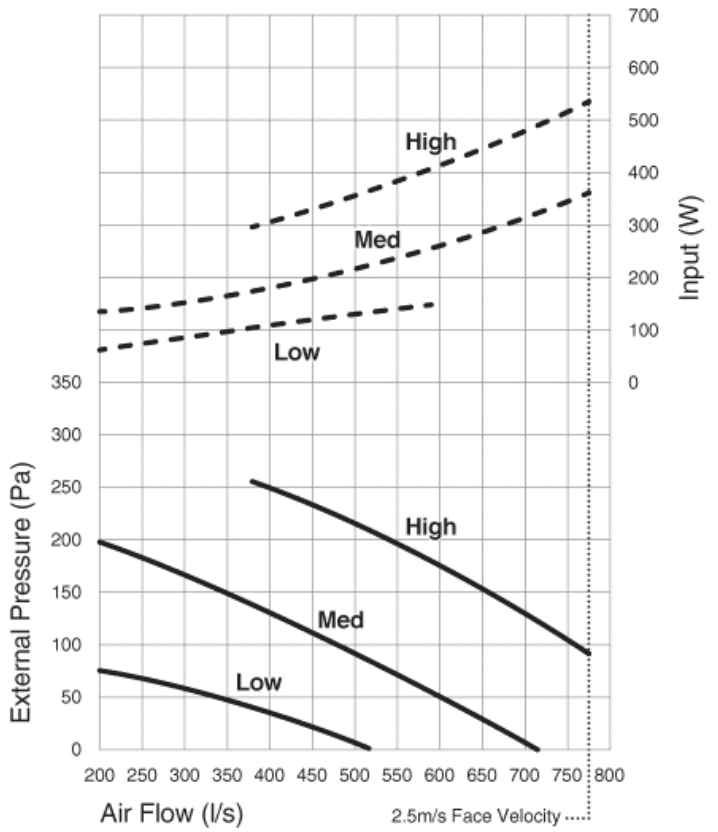

CWP0096 Air Handling Performance
Without Filter

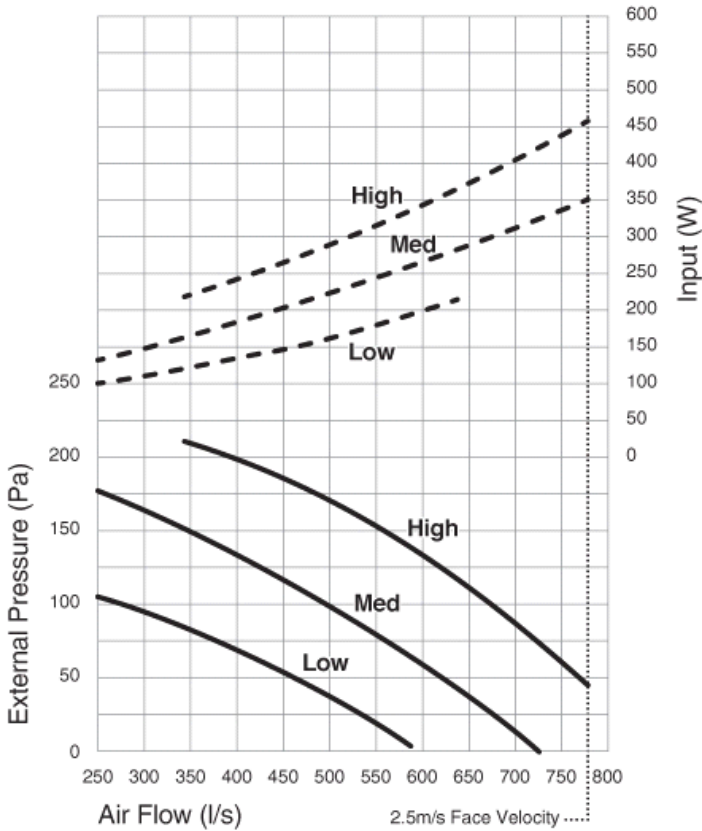

CWP0109 Air Handling Performance
Without Filter

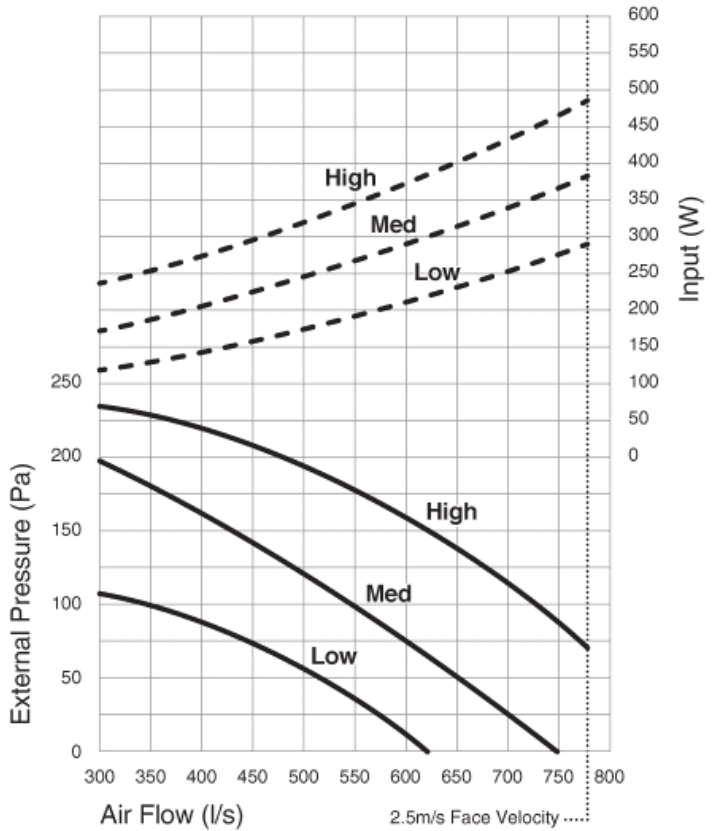

CWP0132 Air Handling Performance Without Filter

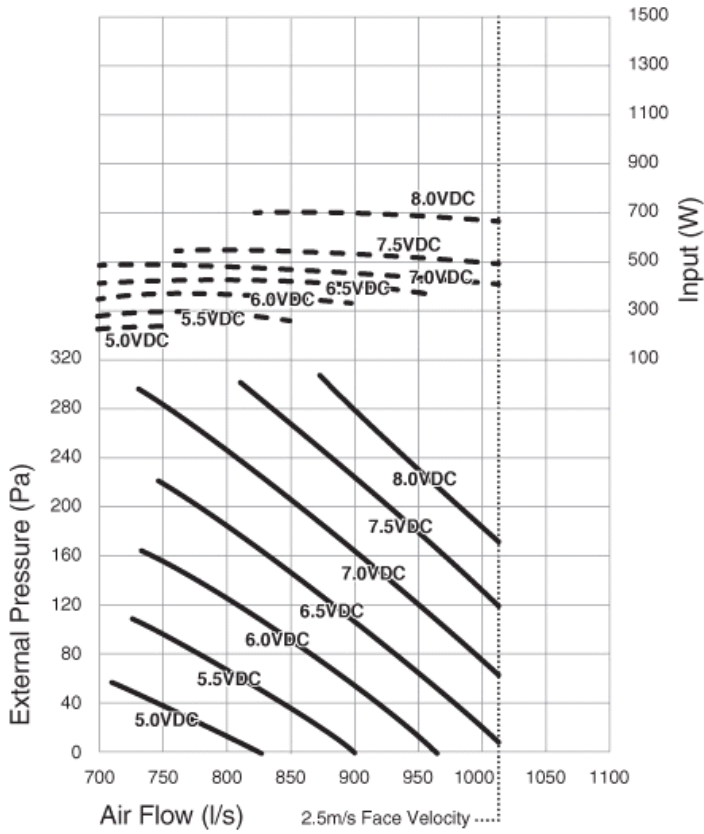

CWP0178 Air Handling Performance Without Filter

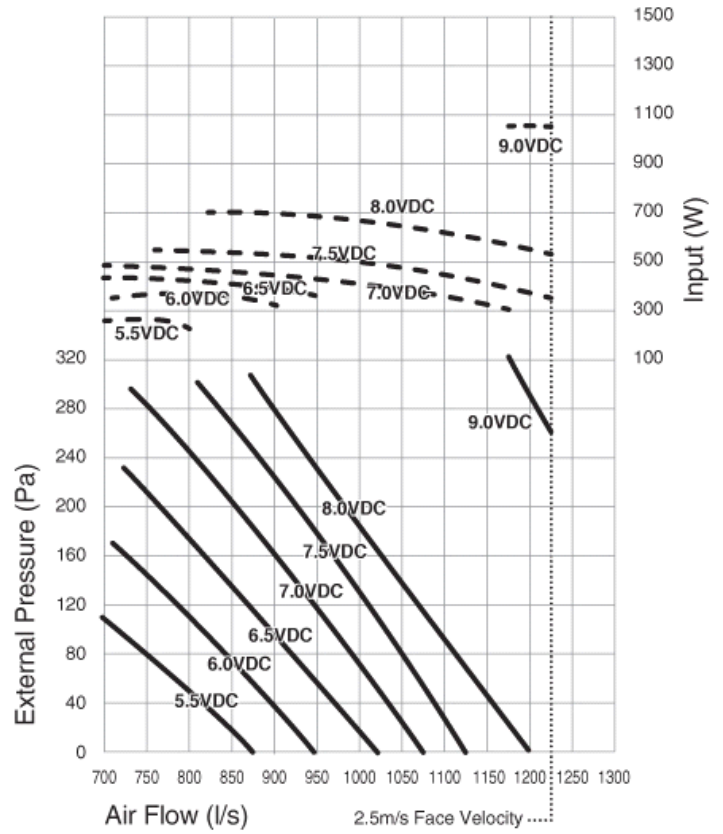

CWP0217 Air Handling Performance Without Filter

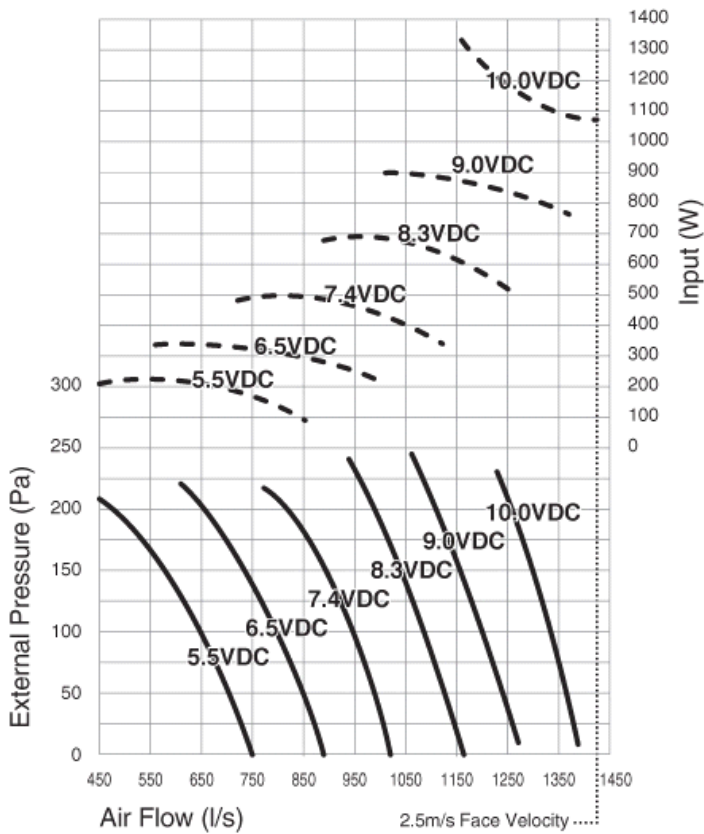

CWP0266 Air Handling Performance Without Filter

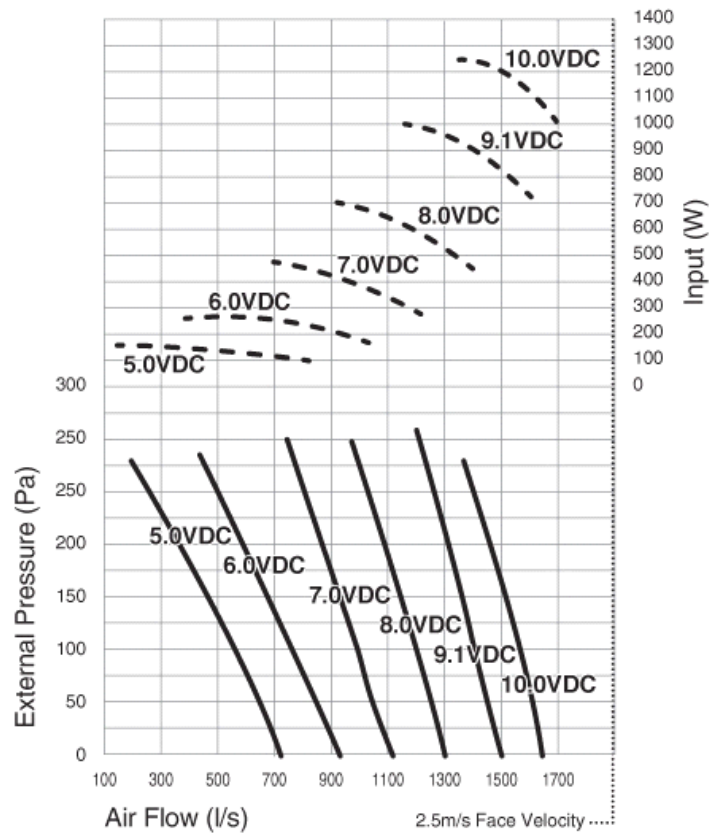

CWP0374 Air Handling Performance Without Filter

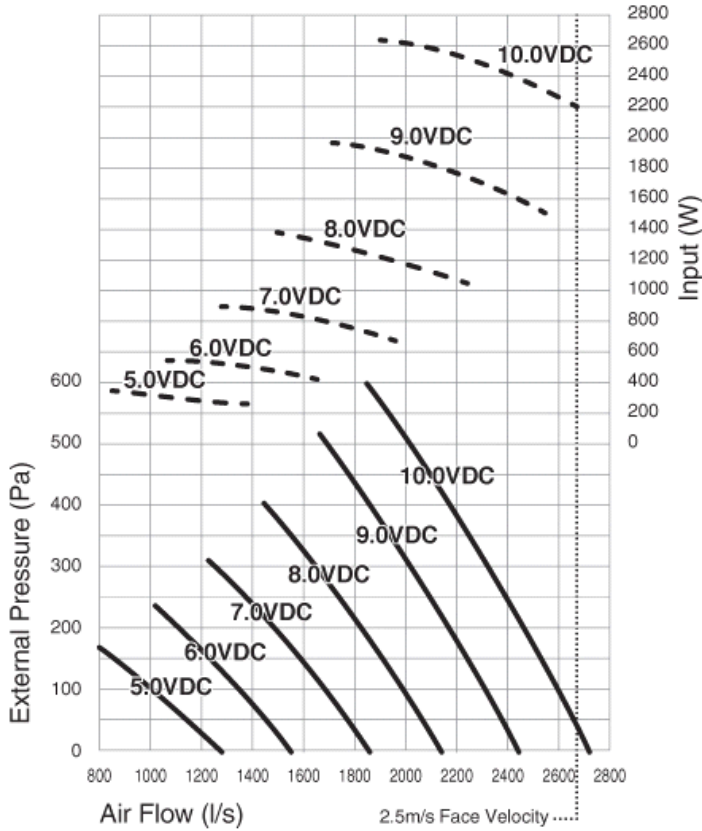

CWP0447 Air Handling Performance Without Filter

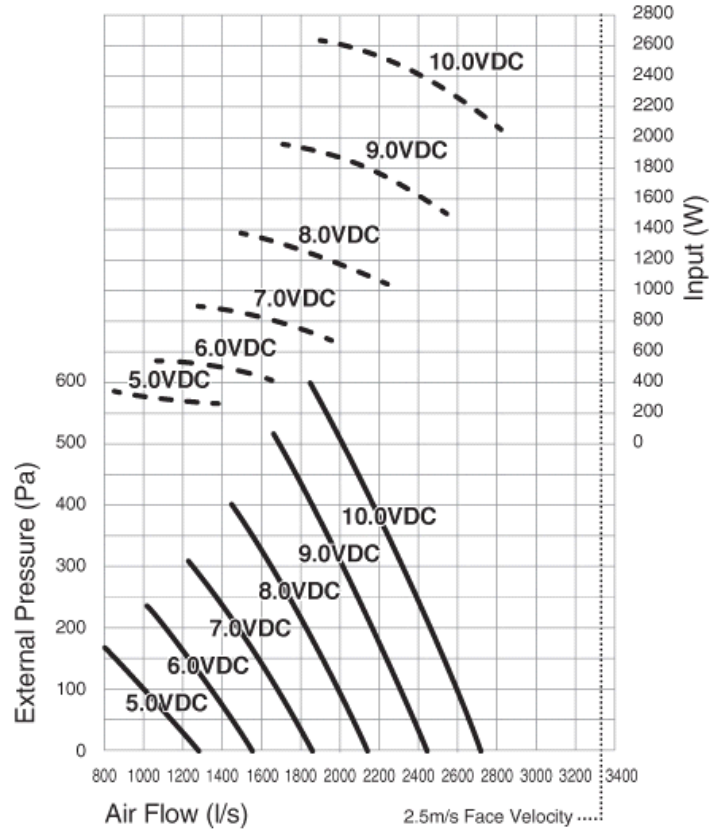

CWP0568 Air Handling Performance Without Filter

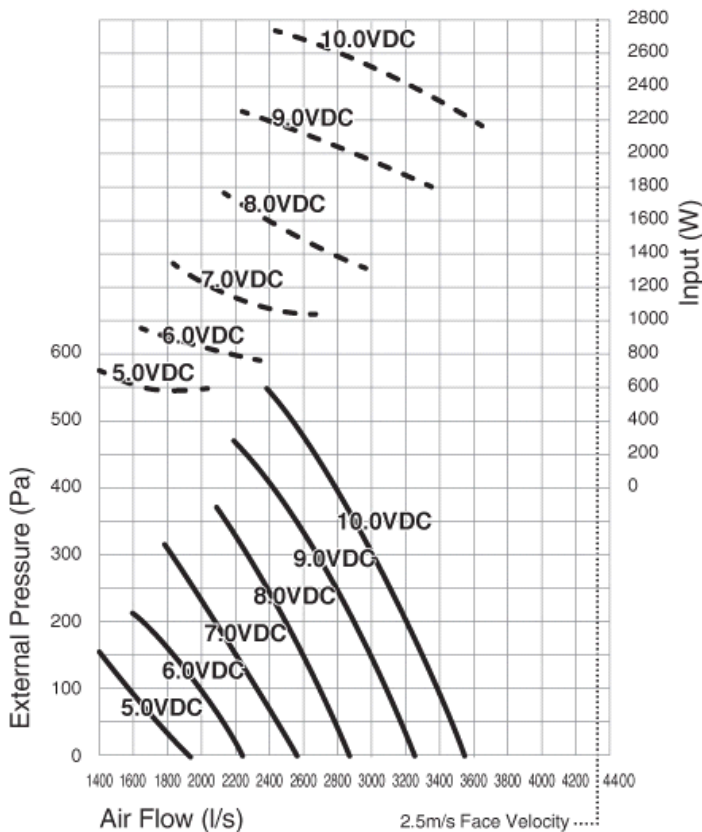

CWP0890 Air Handling Performance Without Filter

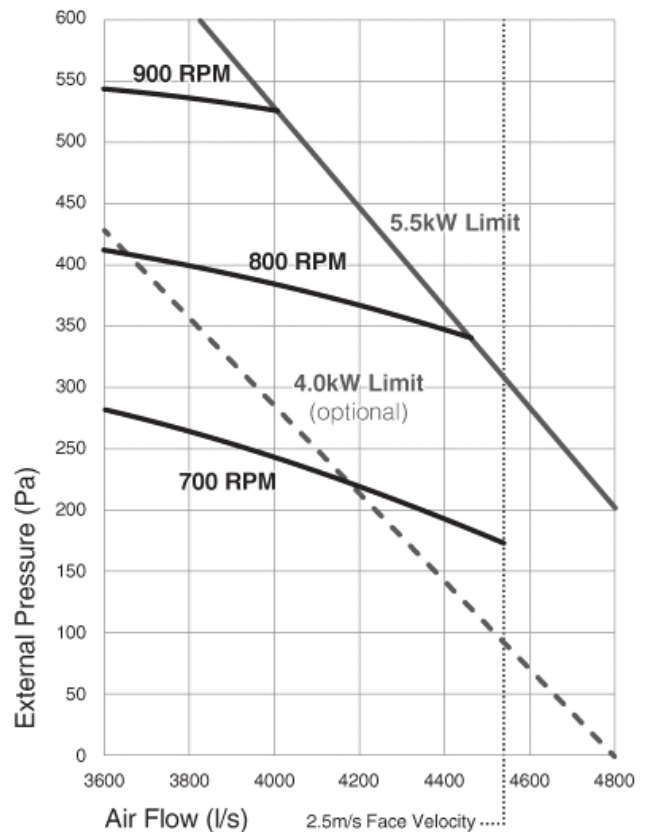

CWP1030 Air Handling Performance

Without Filter

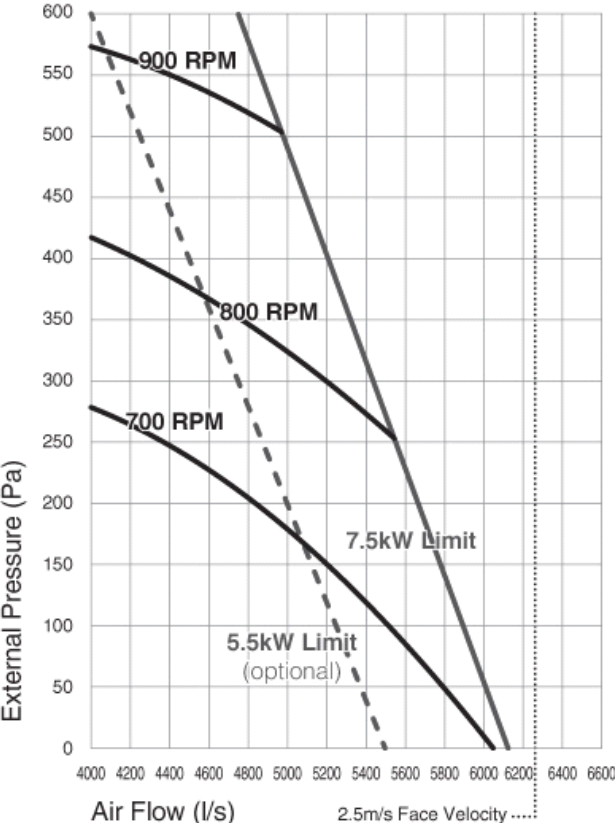

Sound data

Sound measured to AS 8616 (1 metre from source in an anechoic chamber.)

Model	Fan speed	Air flow l/s	Voltage	Sound Pressure Level (SPL) dB(a)	Sound Power Levels (SWL) dB						
					SWL dB(a)	Octave Band					
						125	250	500	1K	2K	4K
CWPO063	Low	405		55.1	63.1	52.2	56.9	61.6	57.5	55.9	51.7
	Med	492		60.4	68.4	55.9	58.1	65.1	63.8	62.5	57.9
	High	581		64.8	72.8	59.8	61.9	69.2	65.7	66.8	63.0
CWPO083	Low	286		55.1	63.1	52.2	56.9	61.6	57.5	55.9	51.7
	Med	522		60.4	68.4	55.9	58.1	65.1	63.8	62.5	57.9
	High	716		64.8	72.8	59.8	61.9	69.2	65.7	66.8	63.0
CWPO096	Low	432		58.7	66.7	54.5	57.0	63.4	62.2	61.3	56.0
	Med	539		63.4	71.4	58.6	60.6	68.0	65.6	65.2	61.4
	High	635		68.2	76.2	63.7	64.6	71.4	72.3	69.8	65.9
CWPO109	Low	487		58.7	66.7	54.4	57.0	63.4	62.2	61.3	56.0
	Med	584		63.4	71.4	58.5	60.5	68.0	65.5	65.2	61.4
	High	687		68.2	76.2	63.7	64.6	71.4	71.3	69.8	65.9
CWPO132	Low		5V	54	62.0	71.8	61.9	58.6	55.2	53.3	44.5
	Low /Med		6V	58.6	66.6	71.9	64.8	65.6	59.9	58.1	52.4
	Med		7V	62.9	70.9	70.3	68.2	69.4	65.4	63.2	58.2
	Hi		8V	66.3	74.3	71.1	73.9	72.3	68.5	66.7	62.5
CWPO178	Low		5V	54	62.0	71.8	61.9	58.6	55.2	53.3	44.5
	Low /Med		6V	58.6	66.6	71.9	64.8	65.6	59.9	58.1	52.4
	Med		7V	62.9	70.9	70.3	68.2	69.4	65.4	63.2	58.2
	Hi		8V	66.3	74.3	71.1	73.9	72.3	68.5	66.7	62.5
CWPO217	Low		5V	57.0	65.0	74.8	64.9	61.6	58.2	56.3	47.5
	Low /Med		6V	61.6	69.6	74.9	67.8	68.6	62.9	61.1	55.4
	Med		7V	65.9	73.9	73.3	71.2	72.4	68.4	66.2	61.2
	Hi		8V	69.3	77.3	74.1	76.9	75.3	71.5	69.7	65.5
CWPO266	Low		5V	54	62.0	71.8	61.9	58.6	55.2	53.3	44.5
	Low /Med		6V	58.6	66.6	71.9	64.8	65.6	59.9	58.1	52.4
	Med		7V	62.9	70.9	70.3	68.2	69.4	65.4	63.2	58.2
	Hi		8V	66.3	74.3	71.1	73.9	72.3	68.5	66.7	62.5
CWPO374	Low		5V	60	68.0	77.8	67.9	64.6	61.2	59.3	50.5
	Low /Med		6V	64.6	72.6	77.9	70.8	71.6	65.9	64.1	58.4
	Med		7V	68.9	76.9	76.3	74.2	75.4	71.4	69.2	64.2
	Hi		8V	72.3	80.3	77.1	79.9	78.3	74.5	72.7	68.5

Sound Pressure Levels (SPL) Within A Room

Deduct the room absorption effect below from the Sound Power Levels (SWL) above to obtain Sound Pressure Levels within a room.

Note: Occupant at least 1.5m from sound source.

ROOM TYPE	OCTAVE BAND FREQ. Hz					
	125	250	500	1k	2k	4k
	ROOM ABSORPTION EFFECT					
SOFT	4	8	11	11	11	11
MEDIUM	3	7	8	9	9	9
HARD	0	1	3	4	4	5

NOTE: The manufacturer reserves the right to change specifications at any time without notice or obligation. Certified data available on request



Sound data continued

Sound measured to AS 8616 (1 metre from source in an anechoic chamber.)

Model	Fan speed	Air flow l/s	Voltage	Sound Pressure Level (SPL) dB(a)	Sound Power Levels (SWL) dB						
					SWL dB(a)	Octave Band					
						125	250	500	1K	2K	4K
CWPO447	Low		5V	57.0	65.0	74.8	64.9	61.6	58.2	56.3	47.5
	Low /Med		6V	61.6	69.6	74.9	67.8	68.6	62.9	61.1	55.4
	Med		7V	65.9	73.9	73.3	71.2	72.4	68.4	66.2	61.2
	Hi		8V	69.3	77.3	74.1	76.9	75.3	71.5	69.7	65.5
CWPO568	Low		5V	57.0	65.0	74.8	64.9	61.6	58.2	56.3	47.5
	Low /Med		6V	61.6	69.6	74.9	67.8	68.6	62.9	61.1	55.4
	Med		7V	65.9	73.9	73.3	71.2	72.4	68.4	66.2	61.2
	Hi		8V	69.3	77.3	74.1	76.9	75.3	71.5	69.7	65.5
CWPO890	700 RPM	4150		74	82.0	80.0	81.0	80.0	77.0	74.0	70.0
	750 RPM	4400		76	84.0	82.0	83.0	82.0	79.0	76.0	72.0
	800 RPM	4750		82	90.0	88.0	89.0	88.0	86.0	82.0	78.0
CWP1030	800 RPM	4400		78	86.0	84.0	85.0	84.0	81.0	78.0	74.0
	825 RPM	4950		81	89.0	87.0	88.0	87.0	84.0	81.0	77.0
	850 RPM	5500		84	92.0	90.0	91.0	90.0	87.0	84.0	80.0

Sound Pressure Levels (SPL) Within A Room

Deduct the room absorption effect below from the Sound Power Levels (SWL) above to obtain Sound Pressure Levels within a room.

Note: Occupant at least 1.5m from sound source.

ROOM TYPE	OCTAVE BAND FREQ. Hz					
	125	250	500	1k	2k	4k
	ROOM ABSORPTION EFFECT					
SOFT	4	8	11	11	11	11
MEDIUM	3	7	8	9	9	9
HARD	0	1	3	4	4	5

NOTE: The manufacturer reserves the right to change specifications at any time without notice or obligation. Certified data available on request



Dimension Drawing CWP0063 to CWP0109

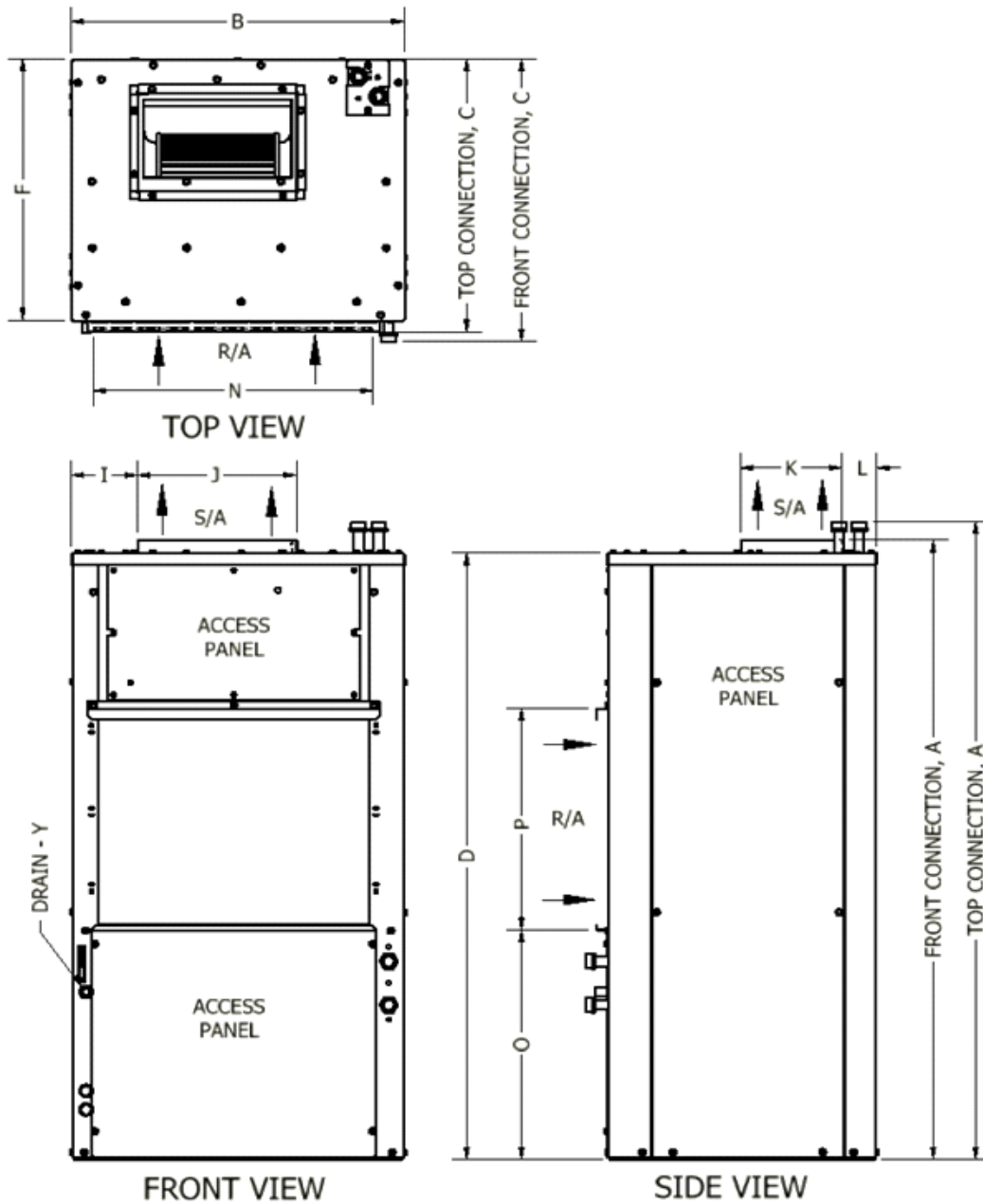

Model	Configuration	A	B	C	D	F	I	J	K	L	N	O	P	Y - Drain	Water Connection
CWP0063	Top Connection	1430	740	626	1358	600	147	353	225	78	622	494	508	Ø19mm (¾")	Ø19mm (¾")
	Front Connection	1390	740	650	1358	600	147	353	225	78	622	494	508	Ø19mm (¾")	Ø19mm (¾")
CWP0083	Top Connection	1465	740	626	1390	600	147	353	225	78	622	526	508	Ø19mm (¾")	Ø25mm (1")
	Front Connection	1420	740	650	1390	600	147	353	225	78	622	526	508	Ø19mm (¾")	Ø25mm (1")
CWP0096	Top Connection	1465	740	626	1390	600	147	353	225	78	622	526	508	Ø19mm (¾")	Ø25mm (1")
	Front Connection	1420	740	650	1390	600	147	353	225	78	622	526	508	Ø19mm (¾")	Ø25mm (1")
CWP0109	Top Connection	1465	740	626	1390	600	147	353	225	78	622	526	508	Ø19mm (¾")	Ø25mm (1")
	Front Connection	1420	740	650	1390	600	147	353	225	78	622	526	508	Ø19mm (¾")	Ø25mm (1")



Dimension Drawing CWP0132 to CWP0178

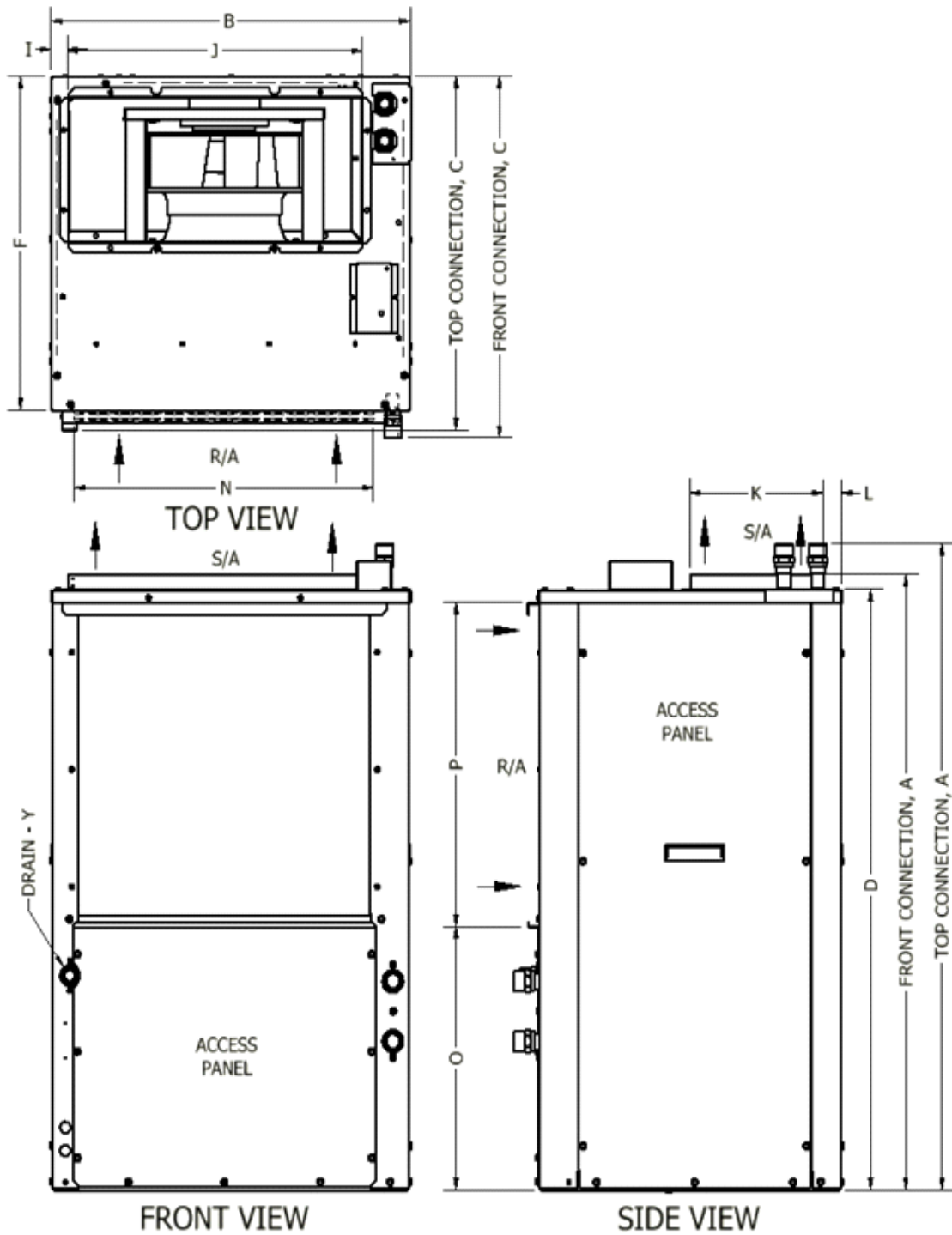

Model	Configuration	A	B	C	D	F	I	J	K	L	N	O	P	Y - Drain	Water Connection
CWP0132	Top Connection	1400	855	765	1297	721	39	700	317	43	710	568	700	Ø25mm (1")	Ø32mm (1¼")
	Front Connection	1360	855	780	1297	721	39	700	317	43	710	568	700	Ø25mm (1")	Ø32mm (1¼")
CWP0178	Top Connection	1400	855	765	1297	721	39	700	317	43	710	568	700	Ø25mm (1")	Ø32mm (1¼")
	Front Connection	1360	855	780	1297	721	39	700	317	43	710	568	700	Ø25mm (1")	Ø32mm (1¼")



Dimension Drawing CWP0217 to CWP0374

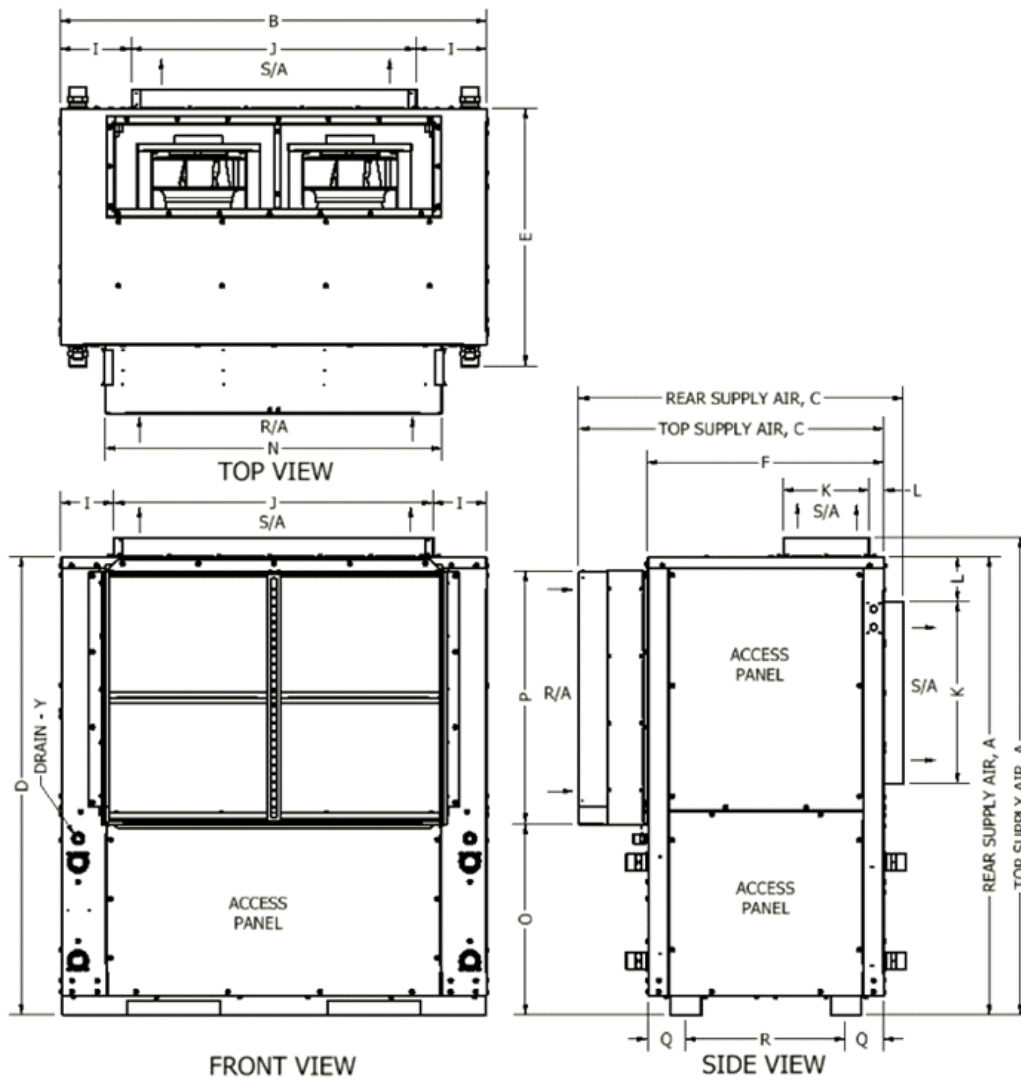

Model	Configuration	A	B	C	D	E	F	I	J	K	L	N	O	P	Q	R	Y - Drain	Water Connection
CWP0217	Top S/A, (Std)	1490	1320	970	1321	906	845	191	938	305	54	1000	732	632	135	571	Ø25mm (1")	Ø38mm (1½")
	Rear S/A,	1420	1320	1035	1321	906	845	252	816	452	133	1000	732	632	135	571	Ø25mm (1")	Ø38mm (1½")
	Top S/A + RA Filters	1490	1320	1090	1321	906	845	191	938	305	54	1000	732	632	135	571	Ø25mm (1")	Ø38mm (1½")
	Rear S/A + RA Filters	1420	1320	1160	1321	906	845	252	816	452	133	1000	732	632	135	571	Ø25mm (1")	Ø38mm (1½")
CWP0266	Top S/A, (STD)	1490	1520	970	1417	906	845	191	1138	305	54	1200	732	632	135	571	Ø25mm (1")	Ø38mm (1½")
	Rear S/A	1420	1520	1035	1417	906	845	252	1016	452	133	1200	732	632	135	571	Ø25mm (1")	Ø38mm (1½")
	Top S/A + R/A Filters	1490	1520	1090	1417	906	845	191	1138	305	54	1200	732	632	135	571	Ø25mm (1")	Ø38mm (1½")
	Rear S/A + R/A Filters	1420	1520	1160	1417	906	845	252	1016	452	133	1200	732	632	135	571	Ø25mm (1")	Ø38mm (1½")
CWP0374	Top S/A, (STD)	1745	1520	970	1671	911	845	191	1138	305	54	1200	715	903	135	571	Ø25mm (1")	Ø51mm (2")
	Rear S/A,	1675	1520	1035	1671	911	845	252	1016	652	160	1200	715	903	135	571	Ø25mm (1")	Ø51mm (2")
	Top S/A + R/A Filters	1745	1520	1090	1671	911	845	191	1138	305	54	1200	715	903	135	571	Ø25mm (1")	Ø51mm (2")
	Rear S/A + R/A Filters	1675	1520	1160	1671	911	845	252	1016	652	160	1200	715	903	135	571	Ø25mm (1")	Ø51mm (2")



Dimension Drawing CWP0447 to CWP0586

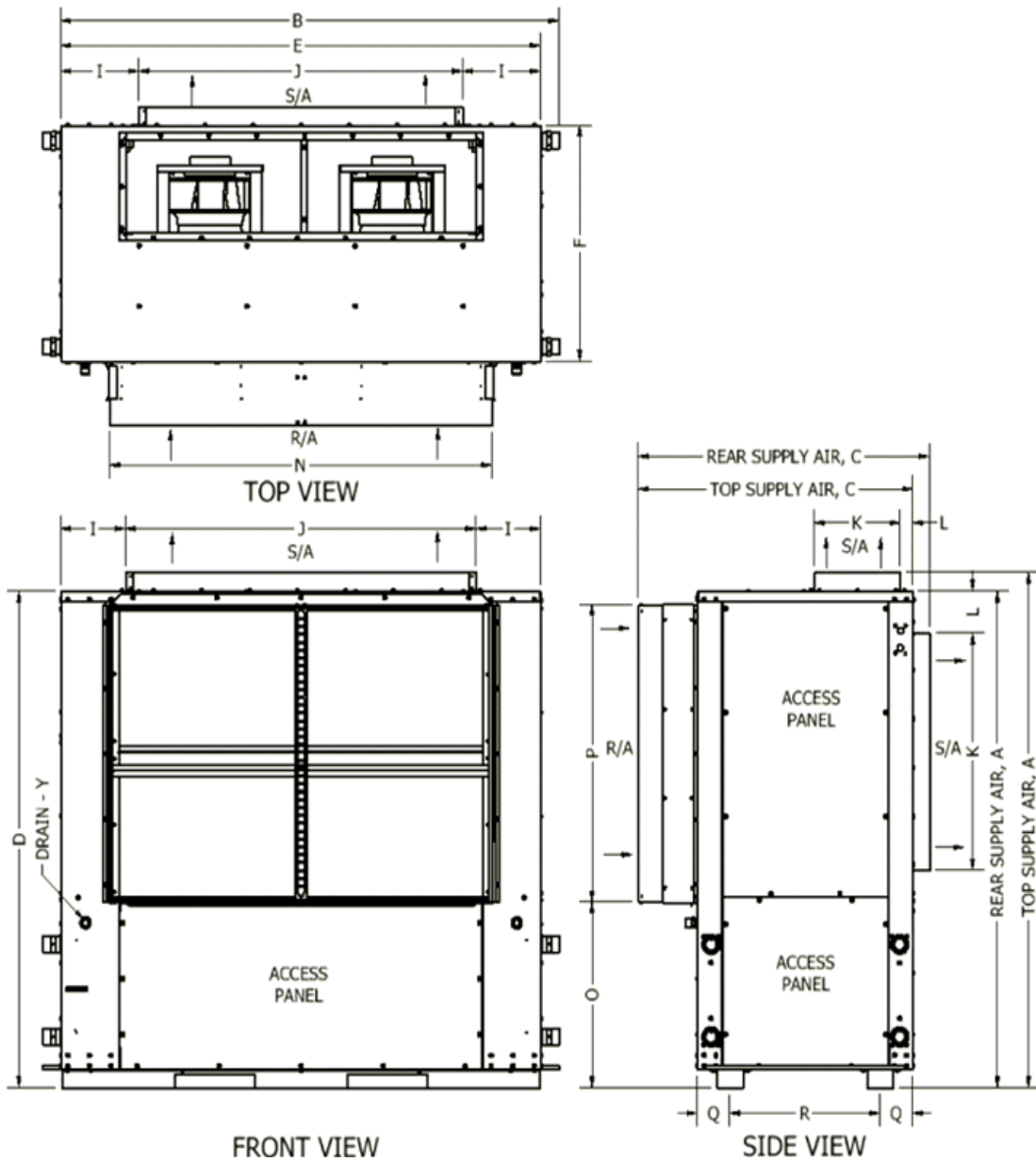

Model	Configuration	A	B	C	D	E	F	I	J	K	L	N	O	P	Q	R	Y - Drain	Water Connection
CWP0447	Top S/A, (STD)	1845	2070	1025	1771	2000	900	270	1460	357	54	1593	815	903	135	626	Ø25mm (1")	Ø51mm (2")
	Rear S/A,	1775	2070	1090	1771	2000	900	325	1350	652	160	1593	815	903	135	626	Ø25mm (1")	Ø51mm (2")
	Top S/A + R/A Filters	1845	2070	1145	1771	2000	900	270	1460	357	54	1593	815	903	135	626	Ø25mm (1")	Ø51mm (2")
	Rear S/A + R/A Filters	1775	2070	1215	1771	2000	900	325	1350	652	160	1593	815	903	135	626	Ø25mm (1")	Ø51mm (2")
CWP0568	Top S/A, (STD)	2100	2070	1025	2025	2000	900	270	1460	357	54	1593	839	1133	135	626	Ø25mm (1")	Ø51mm (2")
	Rear S/A,	2025	2070	1090	2025	2000	900	325	1350	902	160	1593	839	1133	135	626	Ø25mm (1")	Ø51mm (2")
	Top S/A + R/A Filters	2100	2070	1145	2025	2000	900	270	1460	357	54	1593	839	1133	135	626	Ø25mm (1")	Ø51mm (2")
	Rear S/A + R/A Filters	2025	2070	1215	2025	2000	900	325	1350	902	160	1593	839	1133	135	626	Ø25mm (1")	Ø51mm (2")



Dimension Drawing CWP0890 to CWP1030

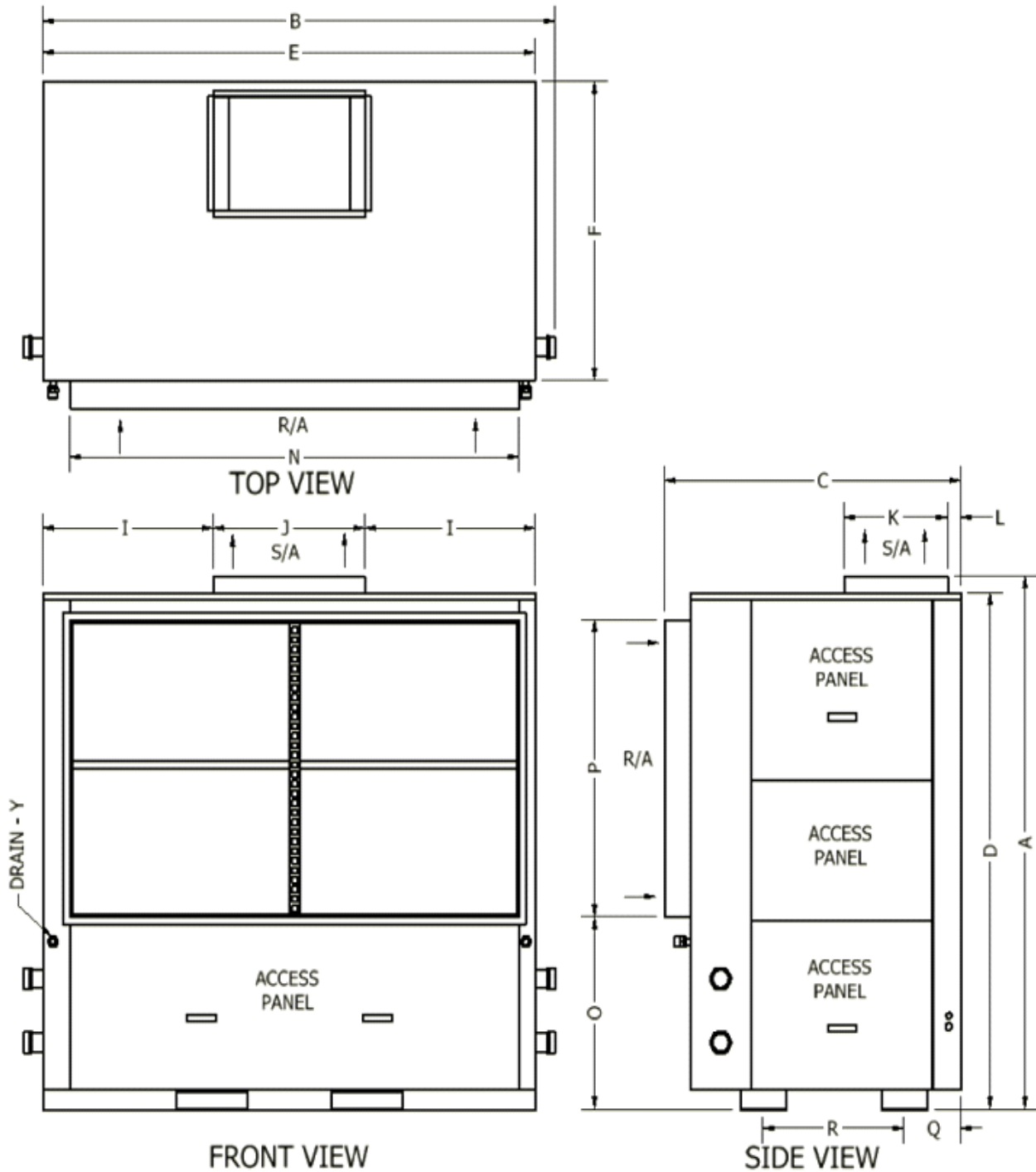

Model	Configuration	A	B	C	D	E	F	I	J	K	L	N	O	P	Q	R	Y - Drain	Water Connection
CWP0890	Top S/A	1905	1990	1160	1834	1860	1090	581	698	479	58	1652	610	1135	260	716	Ø25mm (1")	Ø64mm (2½")
CWP1030	Top S/A	2225	2360	1365	2152	2270	1245	786	698	478	60	2070	802	1239	260	650	Ø32mm (1-1/4")	Ø76mm (3")





temperzone australia pty ltd

Sydney: (02)8822 5700

Brisbane: (07) 33088333

Adelaide: (08) 8340 0607

Tasmania: (03) 63314209

Newcastle: (02) 4962 1155

Perth: (08)9314 3844

Melbourne: (03) 8769 7600

Townsville: (07) 4773 9566

www.temperzone.biz

The Manufacturer reserves the right to change specifications without prior notice.

